



# Quality Products & Sales Inc

## Orifice Metering Division

PO Box 7

Broken Arrow Ok 74013

Local #(918) 251-0115 \* Watts #(800) 444-4634 \* Fax #(918) 455-1982

### Universal Fitting Orifice Plates

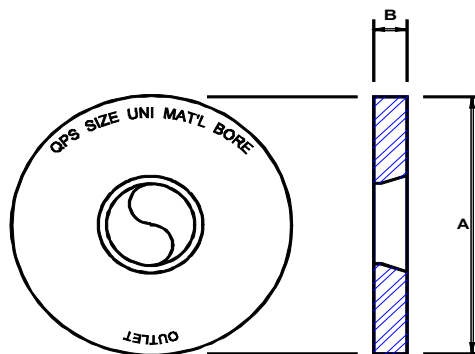

LINE SIZE	PLATE OUTER DIAMETER	SPECIAL OUTER DIAMETER	STANDARD PLATE THICKNESS	LINE SIZE	PLATE OUTER DIAMETER	SPECIAL OUTER DIAMETER	STANDARD PLATE THICKNESS
	<b>A</b>	<b>A+</b>	<b>B</b>		<b>A</b>	<b>A+</b>	<b>B</b>
3/4	1.125	1.125	.125	14	14.563	14.000	.250
1	1.312	1.312	.125	16	16.563	16.000	.375
1-1/2	2.000	2.000	.125	18	18.563	18.000	.375
2	2.437	2.437	.125	20	20.563	20.000	.375
2-1/2	2.812	2.812	.125	24	24.500	24.000	.375
3	3.437	3.437	.125	26	26.750	26.000	.375
4	4.406	4.406	.125	30	30.750	30.000	.500
6	6.437	6.437	.125	34	35.228	*	.500
8	8.437	8.437	.125	36	38.000	*	.500
10	10.687	10.687	.250	42	44.000	*	.750
12	13.079	12.593	.250				

**MATERIALS:** 304 SS., 316 SS., MONEL, HASTELLOY, TITANIUM, TANTALUM, INCONEL, ALLOY 20

*Other materials available upon request*

**Manufactured to meet**

A.G.A. REPORT #3

A.P.I. 14.3.2

ASME SPECIFICATIONS

I.S.O. 9001 SPECIFICATIONS

**Calculations available using equations**

A.G.A. REPORT #3

API-2530

ASME MFC-3M

ISO-5167

**NOTE 1:** (A) Outer diameters are for use with bonded Seal rings .

**NOTE 2:** (A+) Outer diameters are for use in RTJ holders, slip dual and Teflon Seal rings.

#### Seal Rings

Available in all sizes, styles and materials

*Dual and Single Chamber fittings sold separate*